

# GREAT PULTENEY STREET GALLERY

*A Grade II listed Georgian terrace in a fantastic Soho location*

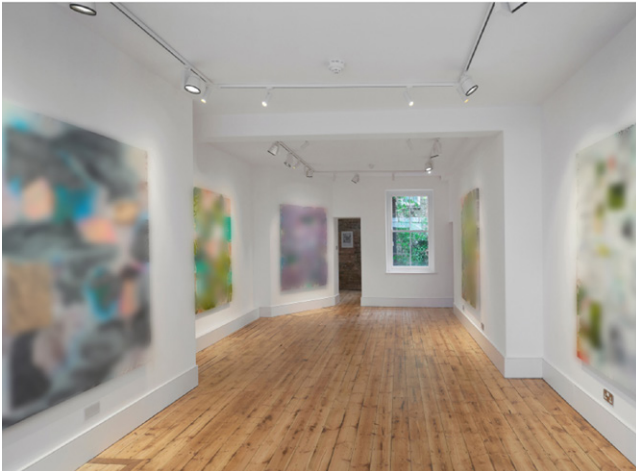

Our 90 sqm gallery is situated on the ground and lower ground floors of 36 Great Pulteney Street, in the heart of London's buzzy and fashionable Soho district.

The building is owned by Soho Housing Association and is a Grade II listed property in a row of beautiful Georgian terraces.

Soho Housing Association was founded in 1974, its mission to provide affordable housing in central London.

36 Great Pulteney Street has a particular place in our history, being one of the first buildings

we purchased during the earliest days of our existence as a housing provider.

The association's portfolio of commercial properties serves to support its primary purpose of maintaining and building affordable housing in the capital's centre.

We are proud to offer Great Pulteney Street gallery for solo and group exhibitions, to individuals and artist groups exhibiting in a wide range of media. We are close to many of London's leading commercial and public art galleries, as well as being in perfect reach of Soho's numerous bars, cafés and restaurants.

## KEY FEATURES

- Three flexible gallery spaces plus office/viewing room
- Gallery 1 - 42 sqm
- Gallery 2 - 27 sqm
- Gallery 1 - 18 sqm
- Wood floors
- High ceilings
- Track lighting
- Natural light
- Storage
- Broadband



36 Great Pulteney Street, London W1F 9NS

**GPS GALLERY**



# GALLERY 1

**Total area:** 42 sqm

**Standing capacity:** 50

Gallery 1 is 42 sqm, and is located on the ground floor, with a large window looking out onto Great Pulteney Street.

There is also a small room adjoining Gallery 1 which can be used as extra viewing space, storage/office space or even as a film projection area.

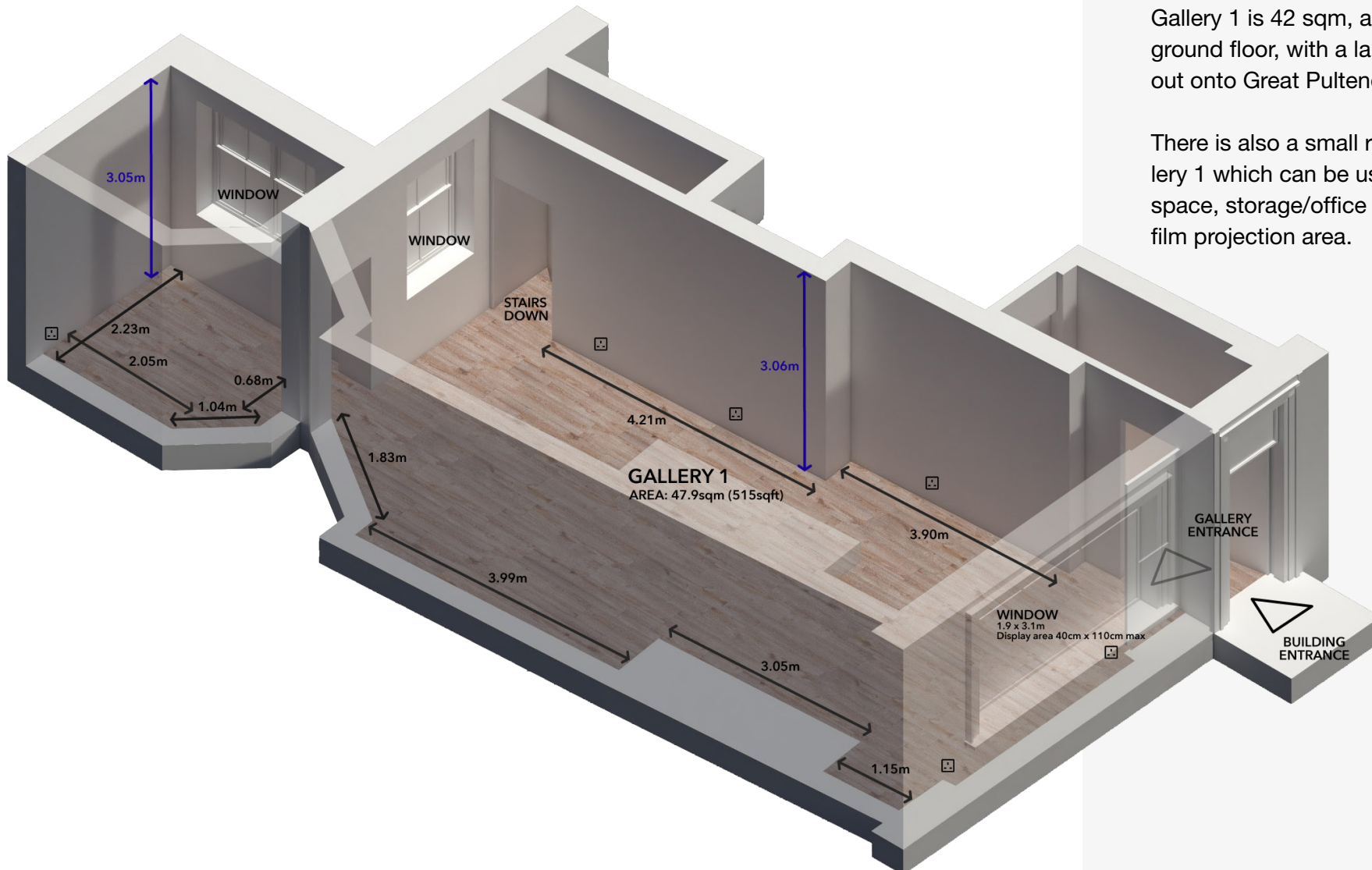

36 Great Pulteney Street, London W1F 9NS

**GPS GALLERY**



# GALLERY 2 & 3

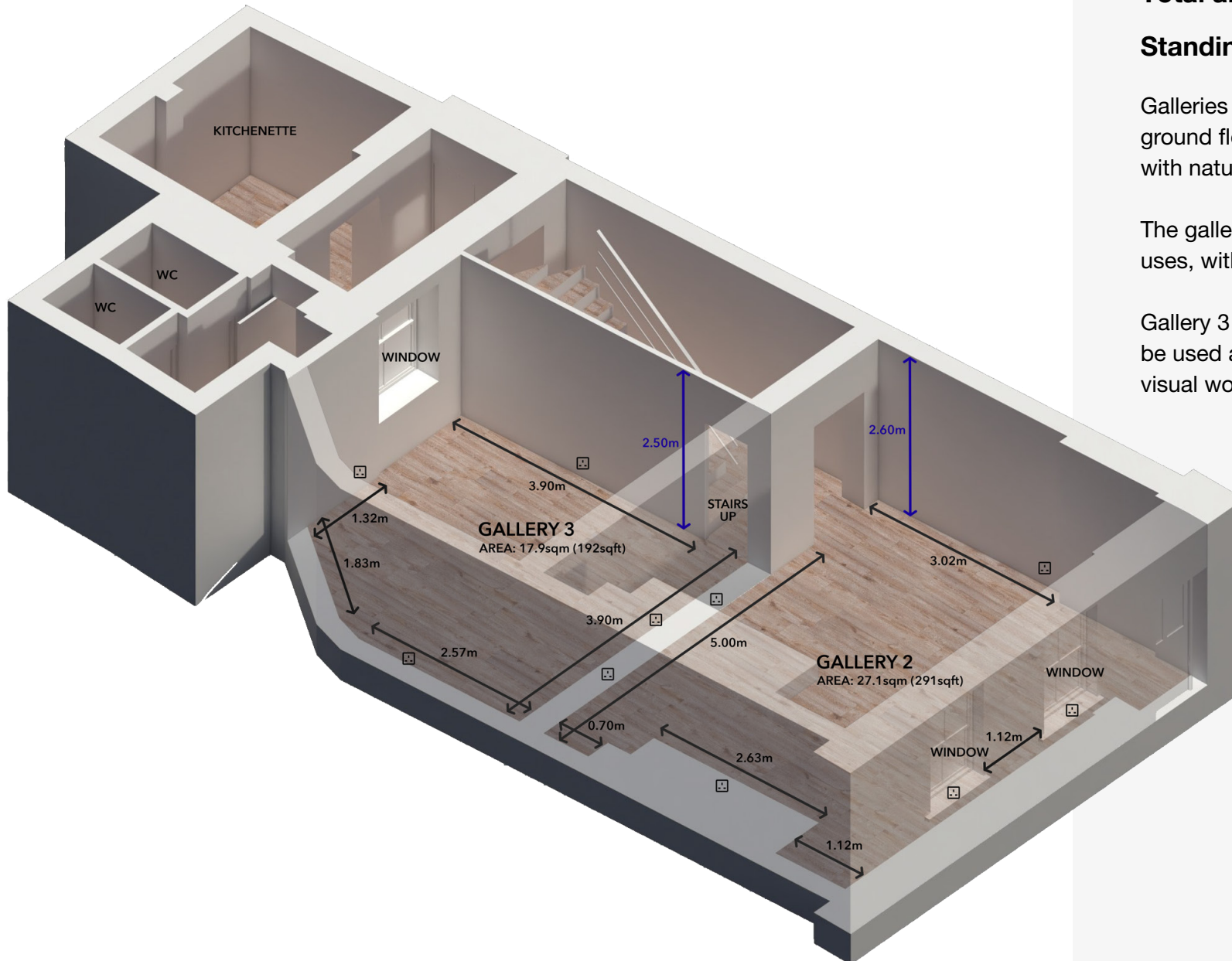

**Total area:** 45 sqm

**Standing capacity:** 50

Galleries 2 & 3 are situated on the lower ground floor of 36 Great Pulteney Street, with natural light and high ceilings.

The galleries lend themselves to a variety of uses, with plenty of wall and floor space.

Gallery 3 in particular has the potential to be used as a room for screening audio-visual work.



36 Great Pulteney Street, London W1F 9NS

**GPS GALLERY**

# FACILITIES

A kitchenette is located on the lower ground floor, and is equipped with a fridge, microwave and dishwasher.

Two toilets are also located on the lower ground floor.

There is internet throughout, as well as two storage areas.

Optional services offered are technical support, photographic documentation, sessional staff, equipment hire and catering services.

The hire period typically runs from Tuesday 9am – Monday 12 noon. The gallery is closed on Sundays.

## TRANSPORT DETAILS

**Tube:** Piccadilly Circus, Oxford Circus, Bond Street, Tottenham Court Road

**Bus:** 38, 14, 19



36 Great Pulteney Street, London W1F 9NS

GPS GALLERY



# TERMS & CONDITIONS

All exhibitors are required to complete an exhibition proposal form with details of artists to be exhibited, dates of any public events, live performances and recorded sound

Please contact us to discuss availability on **07866 063663/info@gpsgallery.co.uk**

- Exhibition hire is usually based on a minimum of one week
- Hire includes installation and de-install days (install/deinstall must take place within the hours 9am-5pm, Mon-Sat only)
- Public opening is typically Tuesday to Saturday, 10am to 6pm
- The gallery is closed on Sundays
- Exhibition insurance is the responsibility of the exhibitor
- Drilling holes in the walls for the installation of artworks is permitted
- Suspending artworks from the ceilings is not permitted, nor is the use of walls outside the three gallery rooms except with express permission
- Unreasonable damage to the gallery will be charged at cost (a returnable deposit against damage will be charged in addition to the hire charge)
- The sale of alcohol is not permitted
- Subletting the premises is not permitted
- Exhibition display graphics on our main window to the street are permitted and must not exceed 40cm high x 110cm wide
- Current pricing is valid until March 2025
- Prices are subject to VAT at prevailing rate
- Extra services such as technical assistance, photographic documentation, projector/plinth hire, sessional staff and catering are available

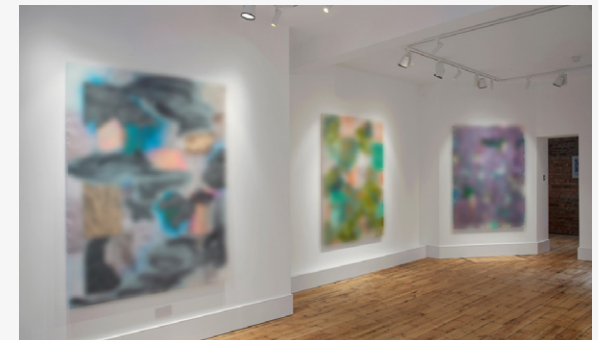

36 Great Pulteney Street, London W1F 9NS

GPS GALLERY

